

# Revolution SLC – Long Cased

## Features & Benefits



The Revolution SLC is a robust range of long cased axial fans, fitted with the renowned, Elta, adjustable pitch aerofoil section bladed impellers. An industry workhorse, this extensive range offers superb performance characteristics, combined with strength, durability and corrosion resistance for a longer life.

- 11 Sizes from 315mm to 1000mm.
- Air Volume flow rates of up to 18.48 m<sup>3</sup>/sec.
- Static Pressures of up to 800 Pa.
- Motors are foot mounted totally enclosed metric type.
- Motors to IP55 with Class 'F' insulation to EN 60034-5.
- Suitable for operating temperatures of up to 54° C.
- Ideal for external or internal use.
- Robust heavy duty hot dipped galvanised steel casings.

**Remember - Revolution SLC is only a selection of the vast range of adjustable pitch axial fans up to 2m diameter available from Elta Fans**

### Features & Benefits

**Cost effective** – High efficiency impellers make this a very economical method of moving high volumes of air at low to medium pressures.

**Material strength** – Revolution SLC axial fans have a robust, heavy duty construction for added strength and durability. Fan casings are heavy gauge, sheet steel, roll formed and welded and hot dipped galvanised after fabrication to BS 729.

**Impeller design** – Adjustable pitch aerofoil section impellers with blades made from high quality pressure die cast aluminium. Hubs are pressure die cast aluminium.

**Choice** – An extensive range of 11 sizes from 315mm to 1000mm diameter means wider performance and greater choice for the engineer.

**Stock availability** – The stocked range of Revolution fans are available on 'Next day' delivery. Standard fans within 10 days which still provides a quick turnaround with urgent projects.

**Flexible performance** – Adjustable pitch impellers mean the pitch angle of the impeller can be adjusted on site (within limits) if a commissioning problem were to occur.

**Inspection access** – All units are supplied with an inspection hole which means the correct rotation of the impeller can be checked for ease of commissioning and general maintenance checks.

**Ease of installation** – The centrally mounted motor is wired via a flexible weatherproofed cable system to an externally located IP55 protected terminal box.

**Integral flanges** – Casings have integral spun flanges for a smooth airflow.

**Full accessory range** – Speed controllers, inverters, flexible connectors and clips, matching flanges, anti-vibration mounts, mounting feet, silencers, wire guards, bell mouth inlets and non return dampers - All selected in advance to match the fan, which means this avoids any on site installation and fitting problems.

**Tested to the very latest standards** – SLC units are tested to ISO 5801:1997 (airside performance) and to BS 848 Pt 2:1985 (sound performance) at Elta Fans own test facility, meaning accurate, up to date information on performance and noise data that can be relied upon.

**Quality assurance** – All units are designed and manufactured with procedures as defined in BS EN ISO 9001: 2000.

**Warranty** – Each Revolution SLC has a 12 month warranty.

### Applications

Kitchen canopy systems, agriculture, sports halls, industrial units, warehousing, factories, schools, air conditioning units, cooling towers, stations, marine, airports, hotels.

# Revolution SLC - Long Cased

## Dimensional Data

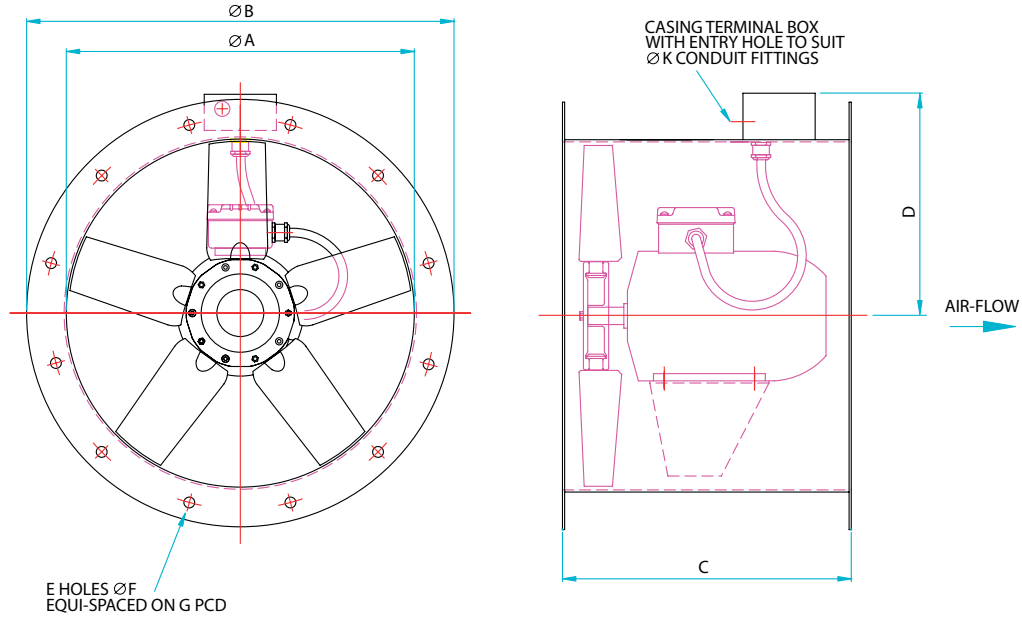

AXIAL FLOW

Product Code	Fan Dia A	B	C	D	E	F	G	K	Weight kg	
									1Ph	3Ph
SLC315	315	375	300	225	8	10	355	20	17	17
SLC355	355	425	375	245	8	10	395	20	21	26
SLC400	400	475	400	265	8	12	450	20	27	31
SLC450	450	530	375	290	8	12	500	20	30	30
SLC450/2-3B	450	530	450	290	8	12	500	25	-	45
SLC500	500	585	400	315	12	12	560	20	33	33
SLC500/2-3	500	585	450	315	12	12	560	25	-	52
SLC560	560	645	400	345	12	12	620	20	40	40
SLC560/2-3	560	645	570	345	12	12	620	25	-	96
SLC630	630	715	400	380	12	12	690	20	50	47
SLC630/4-3B	630	715	450	380	12	12	690	20	-	58
SLC710	710	795	450	420	16	12	770	20	-	70
SLC710/4-3B	710	795	450	420	16	12	770	25	-	72
SLC800	800	885	450	465	16	12	860	25	-	75
SLC800/4-3B	800	885	570	465	16	12	860	25	-	97
SLC900/8-3	900	1000	450	465	16	15	970	25	-	107
SLC900/6-3A	900	1000	450	515	16	15	970	25	-	107
SLC900/6-3B	900	1000	570	515	16	15	970	25	-	127
SLC900/4-3A	900	1000	570	515	16	15	970	25	-	135
SLC900/4-3B	900	1000	710	515	16	15	970	32	-	183
SLC1000	1000	1110	590	565	16	15	1070	25	-	143
SLC1000/4-3B	1000	1110	790	565	16	15	1070	32	-	222
SLC1000/4-3C	1000	1110	790	565	16	15	1070	32	-	239

## Accessories

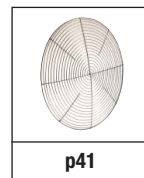
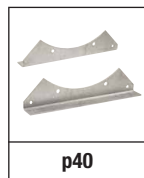
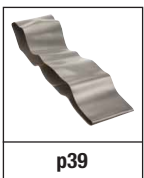

# Revolution SLC - Long Cased Performance & Electrical Data



## SINGLE Phase - 220V-240V / 50Hz

Product Code	Speed r/min	Airflow m <sup>3</sup> /s @ Static Pressure Pa.										Motor Electrical Data			A.V. Mounts	Speed Control		dBA @ 3m
		0	50	100	150	200	250	300	400	500	600	FLC Amps	SC Amps	Output kW		Electr- onic	Trans- former	
SLC315/4-2	1300	0.63	0.55	0.38								1.09	2.30	0.12	S1G	EL31	TC12	45
SLC315/2-1	2750	1.26	1.20	1.13	1.06	0.98	0.87	0.71				3.20	9.77	0.55	S1G	-	-	54
SLC355/4-2	1300	0.85	0.76	0.63								1.51	3.69	0.18	S1G	EL31	TC12	48
SLC355/2-1	2820	1.42	1.39	1.36	1.32	1.30	1.26	1.22	1.13	1.01		6.30	20.0	1.1	S1G	-	-	64
SLC400/4-2	1350	1.44	1.32	1.15								2.56	5.93	0.37	S1G	EL31	TC14	52
SLC400/2-1	2780	2.07	2.03	1.98	1.92	1.88	1.84	1.79	1.68	1.53	1.26	8.10	30.1	1.5	S2B	-	-	66
SLC450/4-2A	1350	1.68	1.56	1.40	1.12							2.56	5.93	0.37	S2B	EL31	TC14	55
SLC450/4-2B	1350	2.07	1.89	1.67	1.38							3.70	11.9	0.55	S2B	EL61	TC18	55
SLC450/2-1	2780	3.03	2.93	2.84	2.73	2.62	2.51	2.36	2.00	1.44		8.10	30.1	1.5	S2B	-	-	68
SLC500/4-2A	1350	1.81	1.70	1.57	1.36	1.00						2.56	5.93	0.37	S2B	EL31	TC14	58
SLC500/4-2B	1380	2.58	2.42	2.22	2.00	1.64						4.52	11.3	0.75	S2B	EL61	TC18	58
SLC560/4-2A	1380	2.90	2.78	2.62	2.42	2.10						4.52	11.3	0.75	S2B	EL61	TC18	59
SLC560/4-2B	1350	3.35	3.15	2.96	2.71	2.35						6.28	16.4	1.0	S2B	EL101	TC18	59
SLC630/6-1A	950	2.54	2.28	1.86								2.30	5.25	0.37	S2B	-	-	58
SLC630/6-1B	950	3.31	2.95	2.48								3.92	9.75	0.55	S2B	-	-	58
SLC630/4-2	1350	3.72	3.56	3.36	3.12	2.78	2.22					6.28	16.4	1.0	S2B	EL101	TC18	64

Sound levels are average spherical free field values at 50% peak pressure for comparative purposes only.

## Silencer Data

Product Code	dBA Attenuation		$\Delta P$ (Pa) 1DEP	dBA Attenuation		$\Delta P$ (Pa) 2DEP
	1DENP	1DEP		2DENP	2DEP	
SLC315/4-2	-8	-11	11	-13	-15	18
SLC315/2-1	-9	-12	41	-14	-15	66
SLC355/4-2	-9	-12	17	-14	-16	27
SLC355/2-1	-9	-11	52	-14	-15	82
SLC400/4-2	-9	-12	24	-14	-16	38
SLC400/2-1	-9	-13	47	-15	-17	76
SLC450/4-2A	-9	-12	20	-15	-15	32
SLC450/4-2B	-9	-12	30	-14	-15	47
SLC450/2-1	-10	-16	60	-16	-22	95
SLC500/4-2A	-9	-15	15	-16	-22	25
SLC500/4-2B	-9	-14	30	-14	-15	48
SLC560/4-2A	-9	-15	24	-16	-21	39
SLC560/4-2B	-9	-13	32	-15	-15	51
SLC630/6-1A	-11	-15	12	-16	-23	19
SLC630/6-1B	-11	-14	20	-15	-21	33
SLC630/4-2	-10	-14	25	-15	-25	40

For explanation of silencer data see p20.

## Isolating Vibrating Fans

### DO NOT!

Do not bolt fan directly to the building structure as noise and vibration can be transmitted directly to the building fabric.

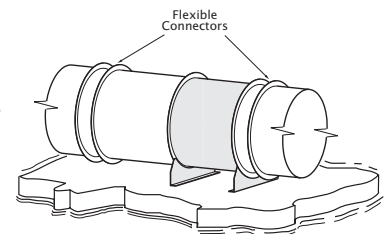

### DO!

Isolate fan and duct from the building structure with fan on neoprene or vibration isolators and suitable flexible connectors.

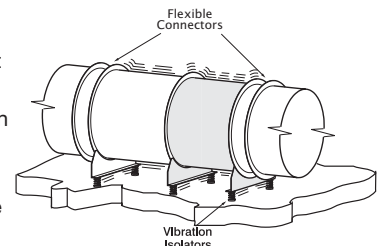

# Revolution SLC - Long Cased Performance & Electrical Data



THREE Phase - 380V-415V / 50Hz

Product Code	Speed r/min	Airflow m <sup>3</sup> /s @ Static Pressure Pa.												Motor Electrical Data			A.V. Mounts	Speed Control Transformer	dBA @ 3m
		0	50	100	150	200	250	300	400	500	600	700	800	FLC Amps	SC Amps	Output kW			
SLC315/4-3	1365	0.64	0.58	0.46										0.44	1.94	0.12	S1G	TC33	46
SLC315/2-3	2780	0.95	0.93	0.91	0.88	0.84	0.82	0.78	0.66					1.40	8.54	0.55	S1G	-	61
SLC355/4-3	1340	0.85	0.77	0.66										0.62	3.22	0.18	S1G	TC33	49
SLC355/2-3A	2800	1.48	1.45	1.42	1.38	1.34	1.31	1.26	1.17	1.03				2.50	17.9	1.1	S1G	-	64
SLC355/2-3B	2840	1.93	1.89	1.85	1.82	1.77	1.73	1.68	1.56	1.40				4.80	33.6	2.2	S2B	-	63
SLC400/4-3	1390	1.42	1.31	1.16										1.12	5.82	0.37	S1G	TC33	52
SLC400/2-3	2840	2.40	2.37	2.34	2.29	2.25	2.22	2.16	2.04	1.88	1.67			4.80	33.6	2.2	S2B	-	67
SLC450/4-3A	1390	1.70	1.57	1.42	1.18									1.12	5.82	0.37	S2B	TC33	56
SLC450/4-3B	1365	2.04	1.88	1.70	1.43									1.57	9.42	0.55	S2B	TC33	56
SLC450/2-3A	2840	2.89	2.82	2.78	2.72	2.66	2.60	2.53	2.39	2.22	2.00			4.80	33.6	2.2	S2B	-	75
SLC450/2-3B	2850	3.83	3.79	3.74	3.69	3.63	3.57	3.50	3.31	3.10	2.84	2.50		8.82	61.7*	4.0	S2B	-	75
SLC500/4-3A	1390	1.72	1.63	1.50	1.30	1.03	0.50							1.12	5.82	0.37	S2B	TC33	58
SLC500/4-3B	1370	2.59	2.41	2.23	2.00	1.62								2.00	11.4	0.75	S2B	-	58
SLC500/4-3C	1380	3.00	2.83	2.60	2.32									2.90	15.4	1.1	S2B	TC33	58
SLC500/2-3A	2850	4.12	4.08	4.02	3.98	3.90	3.84	3.75	3.63	3.46	3.25	3.02	2.70	8.82	61.7*	4.0	S2	-	78
SLC500/2-3B	2935	4.76	4.72	4.68	4.60	4.52	4.46	4.40	4.24	4.08	3.88	3.63	3.32	10.3	82.4*	5.5	S2	-	71
SLC560/4-3A	1370	2.80	2.67	2.52	2.29	1.98								2.00	11.4	0.75	S2B	-	59
SLC560/4-3B	1380	3.50	3.31	3.13	2.88	2.60								2.90	15.4	1.1	S2B	TC33	60
SLC560/4-3C	1390	4.06	3.85	3.60	3.32	2.94								3.70	20.4	1.5	S2B	TC35	60
SLC560/2-3	2920	6.70	6.63	6.51	6.37	6.30	6.18	6.05	5.80	5.53	5.25	4.88	4.50	13.6	92.5*	7.5	S2	-	75
SLC630/6-3A	925	2.78	2.40	1.90										1.11	5.77	0.37	S2B	TC33	57
SLC630/6-3B	920	3.40	3.04	2.48										1.61	8.53	0.55	S2B	TC33	59
SLC630/4-3A	1380	3.69	3.52	3.32	3.08	2.76	2.32							2.50	15.4	1.1	S2B	TC33	64
SLC630/4-3B	1400	5.40	5.17	4.90	4.61	4.30	3.88							5.20	25.0	2.2	S2	TC310	63

AXIAL FLOW

## Silencer Data

Product Code	dBA Attenuation		ΔP (Pa) 1DEP	dBA Attenuation		ΔP (Pa) 2DEP
	1DENP	1DEP		2DENP	2DEP	
SLC315/4-3	-8	-11	12	-13	-15	19
SLC315/2-3	-9	-14	25	-16	-21	40
SLC355/4-3	-9	-12	17	-14	-16	27
SLC355/2-3A	-9	-11	47	-14	-15	77
SLC355/2-3B	-9	-12	80	-14	-15	127
SLC400/4-3	-9	-12	23	-14	-16	37
SLC400/2-3	-9	-11	67	-14	-15	108
SLC450/4-3A	-9	-12	20	-15	-15	30
SLC450/4-3B	-9	-12	32	-14	-15	52
SLC450/2/3A	-9	-16	57	-16	-24	92
SLC450/2/3B	-9	-13	110	-14	-15	177
SLC500/4-3A	-9	-15	12	-16	-21	19
SLC500/4-3B	-9	-12	30	-14	-15	48
SLC500/4-3C	-9	-12	42	-14	-15	67
SLC500/2-3A	-9	-16	72	-16	-24	116
SLC500/2-3B	-10	-13	100	-15	-15	160
SLC560/4-3A	-9	-15	22	-16	-21	36
SLC560/4-3B	-8	-12	35	-14	-15	57
SLC560/4-3C	-8	-12	48	-14	-15	78
SLC560/2-3	-9	-12	120	-14	-15	192
SLC630/6-3A	-11	-15	13	-16	-23	21
SLC630/6-3B	-9	-14	21	-15	-21	34
SLC630/4-3A	-10	-16	25	-15	-25	40
SLC630/4-3B	-10	-14	54	-14	-21	87

Sound levels are average spherical free field values at 50% peak pressure for comparative purposes only.

All starting currents are quoted as direct-on-line. Those marked \* are available for star-delta starting if required.

For sizes 710mm to 1000mm see p38